

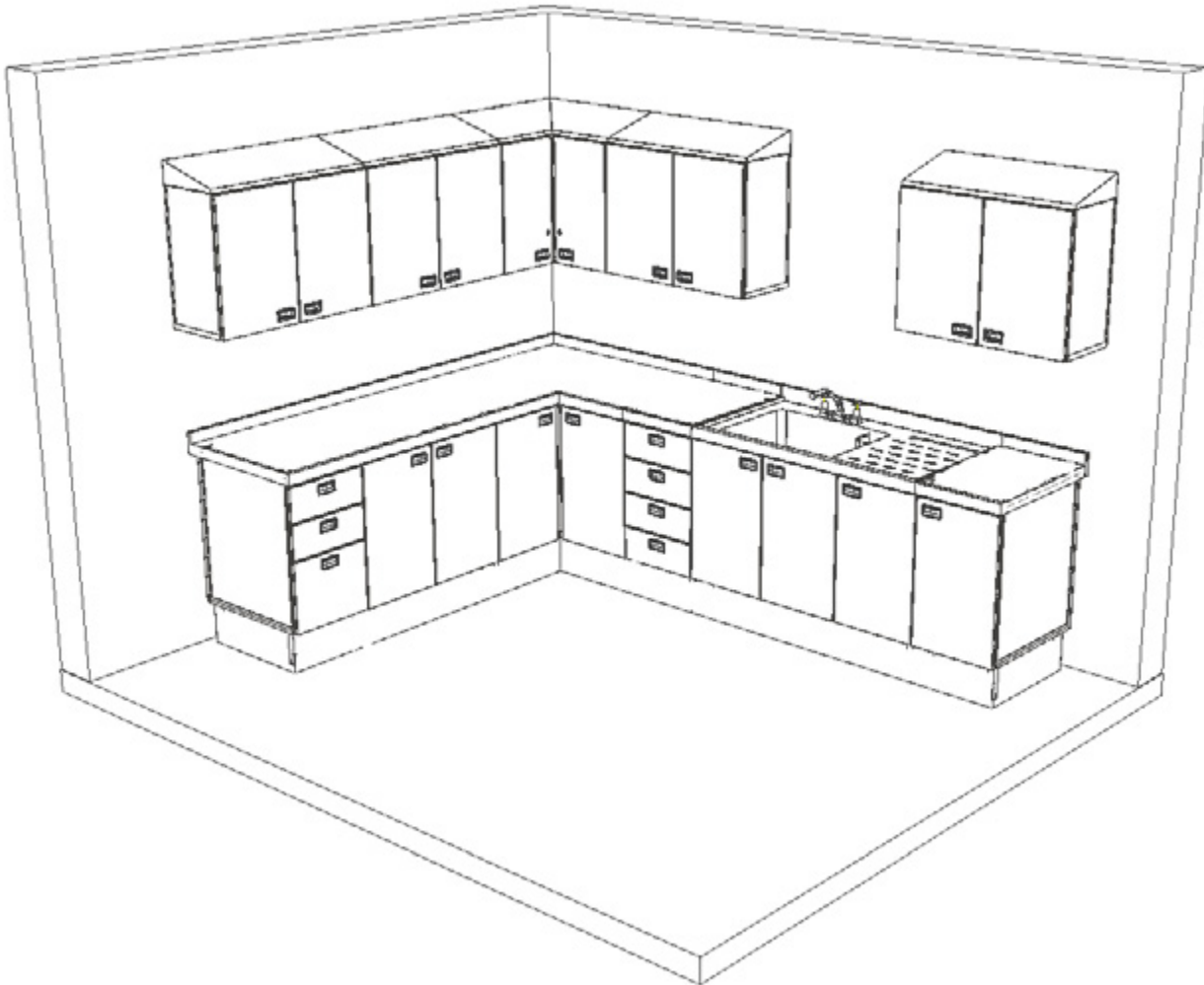

**MULTIPLEX**

# Wall Cupboards & Base Units



## Installation instructions

Manual 030 Issue 001 March 2021



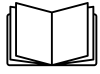

To ensure the best results from these units please take the time to read and follow all safety, installation and maintenance guidelines carefully before proceeding to install. Keep this manual in a safe place for future consultation.



These appliances are marked in compliance with the relevant Low Voltage & EMC Directives. Voltage stated on unit data plate.



**Warning!**

Please pay attention to sections of the manual displaying this symbol.

---

**The appliance must only be used for the purpose it was designed for and may become unsafe if used for any other purpose.  
Operators should be trained.**

**The room where this counter is used must be dry, clean with temperatures between 3°C and 25°C and with a maximum relative humidity of 60%.  
These units are for indoor use only and have an IPX4 rating.**

**Prior to ANY service calls**

Consult individual user manuals for basic fault-finding advice and information required to place the call

Check warranty/maintenance terms and conditions

# Contents

		Page
1	<b>Positioning base units</b>	4 / 5
2	<b>Kick-plates</b>	6
3	<b>Door Hinges</b>	7
4	<b>Drawers</b>	8
5	<b>Wall-cupboard Fitting</b>	9 / 10 / 11 / 12
6	<b>Cleaning</b>	13

## Sliding door models

Model	L x D x H (mm)	Height with sloping roof (mm)
WC8S	800 x 303 x 600	700
WC10S	1000 x 303 x 600	700
WC12S	1200 x 303 x 600	700

## Hinged door models

Model	L x D x H (mm)	Height with sloping roof (mm)
WC4HL/R	400 x 323 x 600	700
WC8H	800 x 323 x 600	700
WC10H	1000 x 323 x 600	700
WC12H	1200 x 323 x 600	700

# 1: Positioning base units

Check designated area for floor level irregularities.

Step 1:

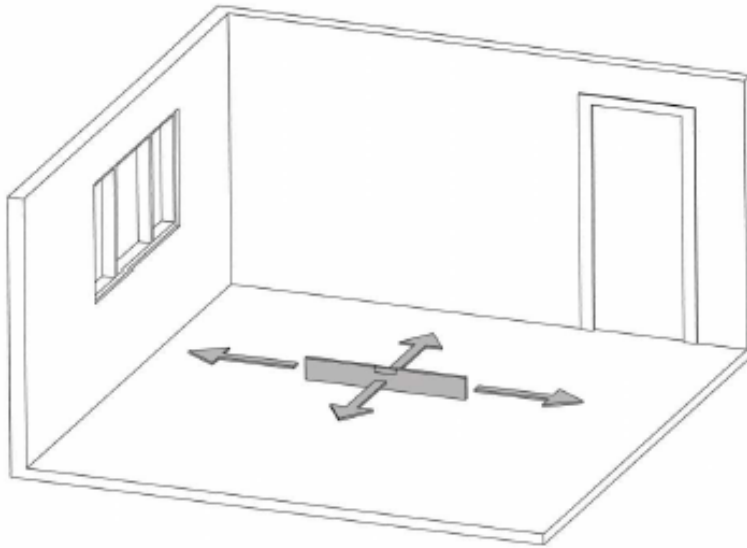

Step 2:

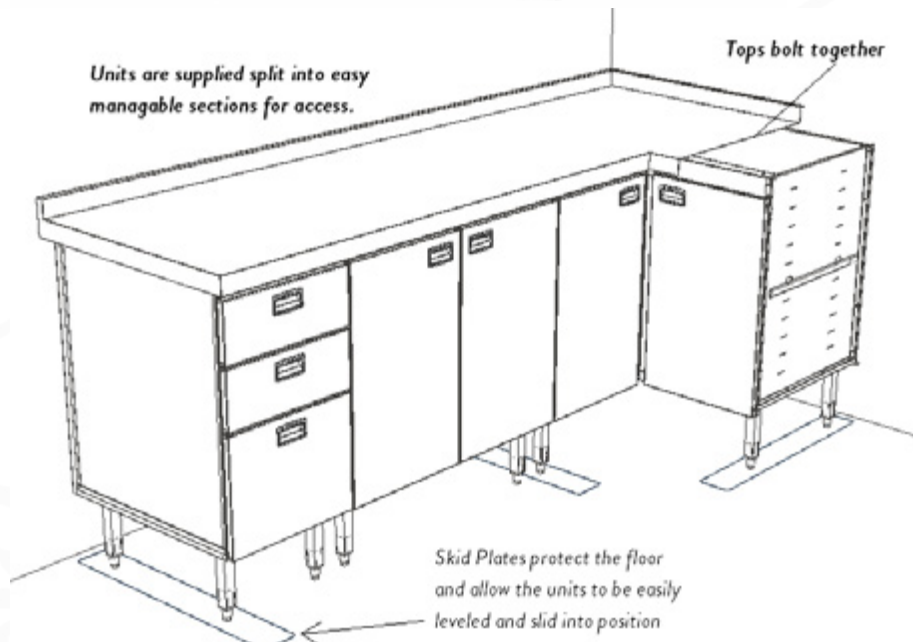

- Lay out skid plates (e.g. 100mm x 1000mm x 1mm approx metal sheet strips) on the floor roughly where the counter module feet will land & place unit on top.
- To eliminate the additional feet snagging on the floor when positioning, temporarily run up the adjustable feet that are not on the skid plates.  
This allows the unit to slide on the feet in contact with the plates
- Whenever possible start at the high end of the floor & position the first unit in its chosen location.
- Check the module unit height from floor to work top, adjust legs and set level.  
(Making sure the skid plates are central to the units legs)

# 1: Positioning base units

## Joining Multiple Modular Units Together

- Step 3 & 4:
- Positioned the next module onto the skid plates and slid up to the first, being careful not to move the first unit out of position.
  - Adjust the legs until it's perfectly aligned and level with the first.
  - Repeat with all other units.

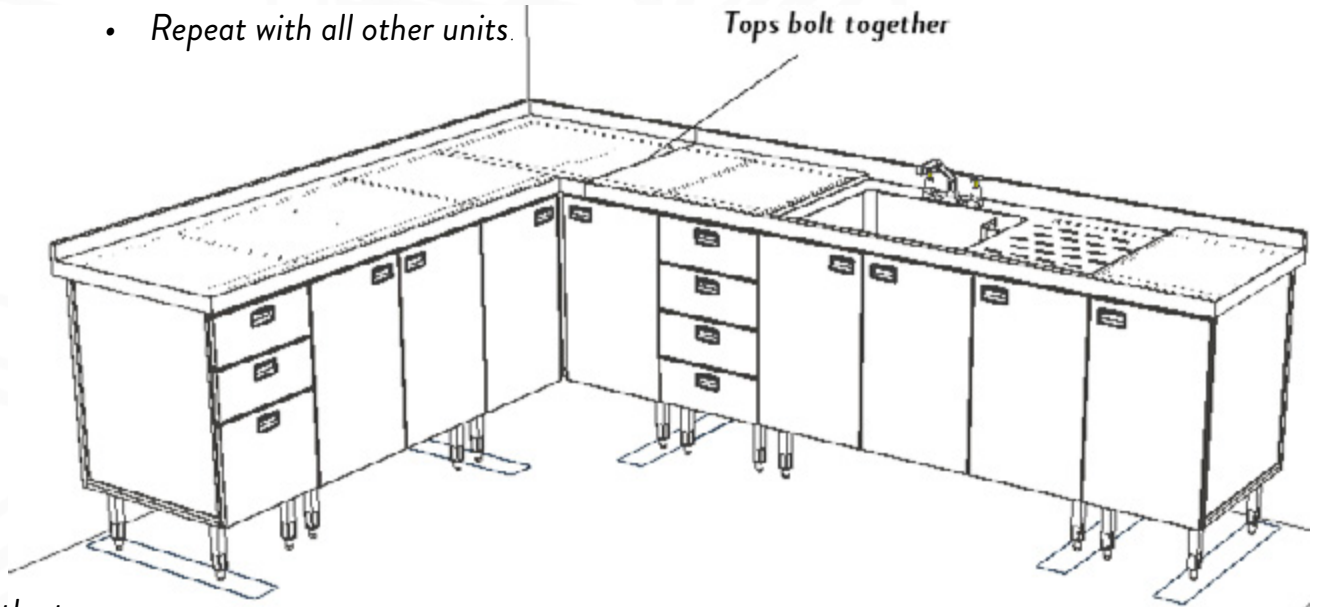

## Joining the tops

- Tighten up joining strap on to the under top weld studs with nuts supplied.  
Warning: do not over tighten [over-tightening may result in broken weld studs]

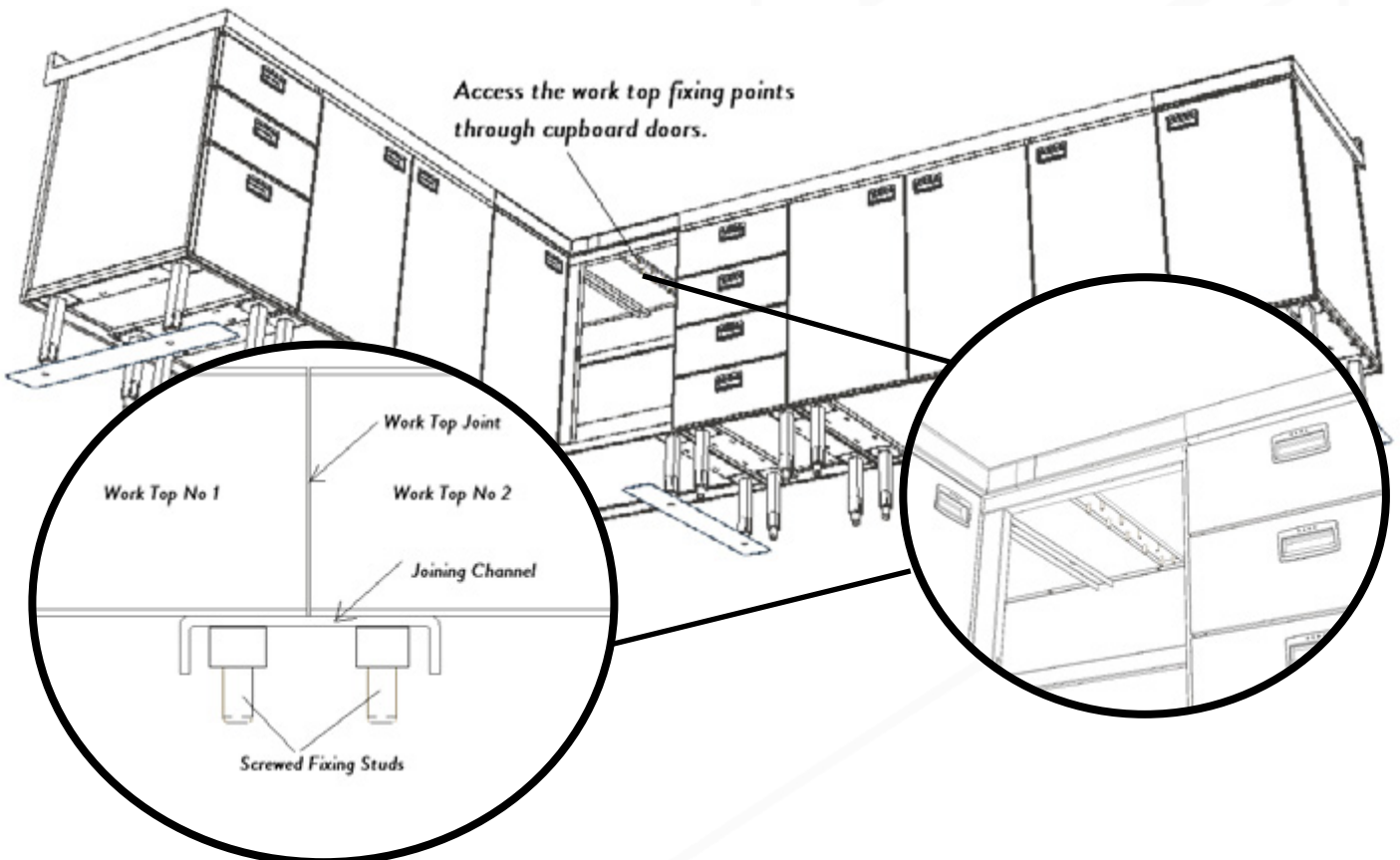

## 2: Kick plates

Kick plates are designed to clip onto the counter legs allowing easy fitting and removal. The leg clips slide freely along the inside of the kick trim.

- Slide the leg clips into the kick plate and line up with legs, push on to the legs to fit.
- Finish off using screw fixings provide at each counter join and on the end plates.

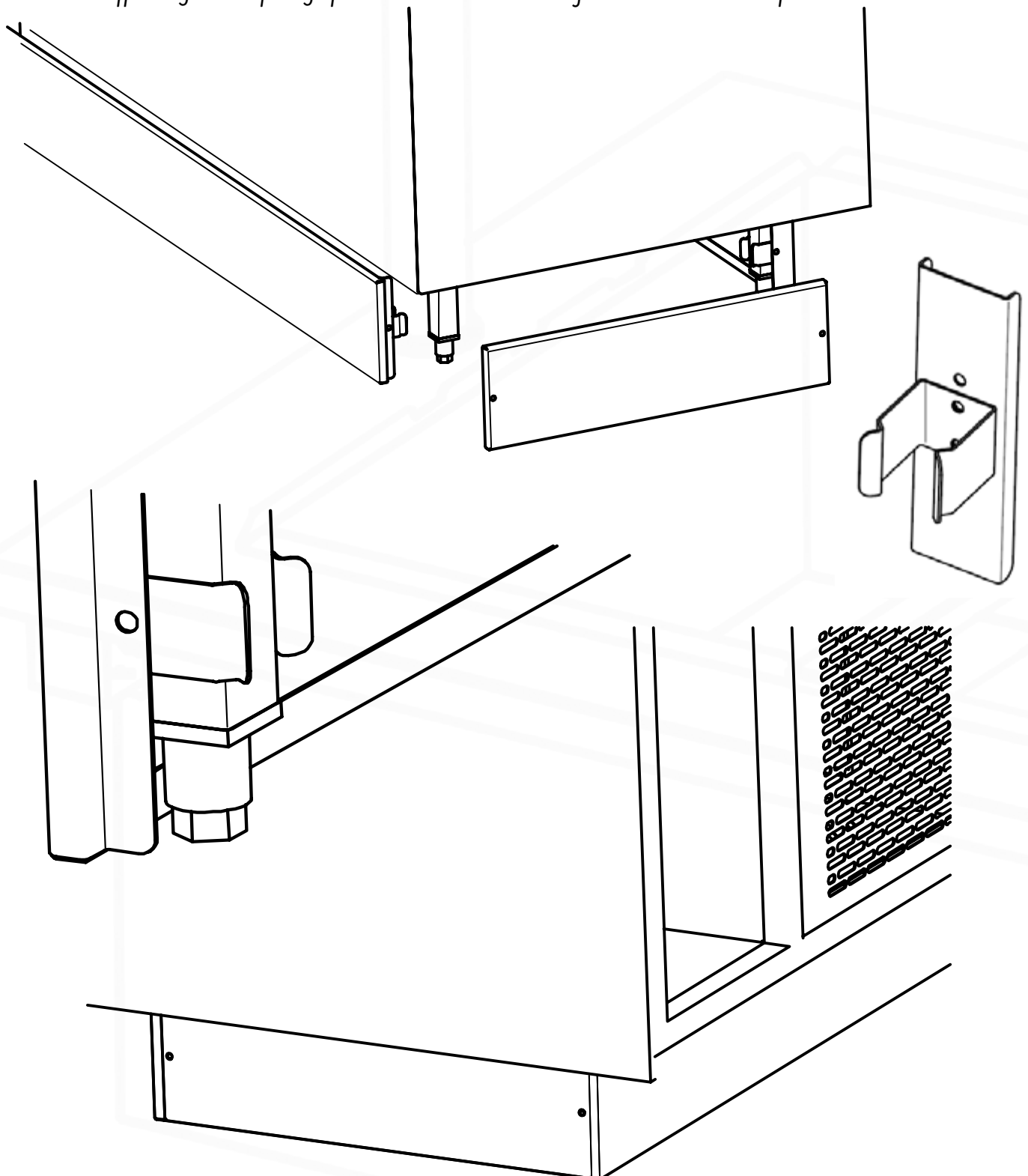



### 3: Door Hinges

#### Clip On Design

This hinge comes supplied with an adjustable clip on mounting plate, which allows the door to be fully adjusted and then quickly removed by simply pushing a small button at the very tip of the hinge. Below diagram shows how the concealed style hinge clips on and off from the mounting plate.

#### Clip On Hinge Instructions

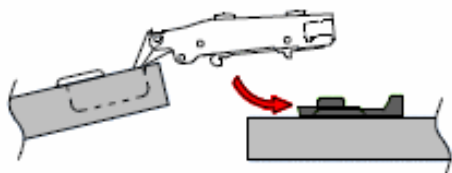

Clamp hinge on to the mounting plate as shown by direction arrow

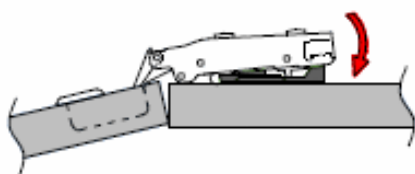

Press down the hinge arm to lock the plate as shown

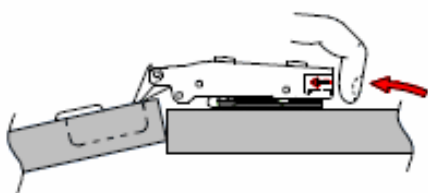

The door can be quickly removed by pushing the button

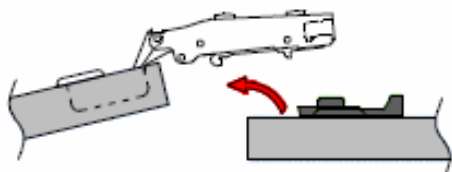

Unclipping the door from the mounting plate leaves all adjustments unaltered

#### Adjustment

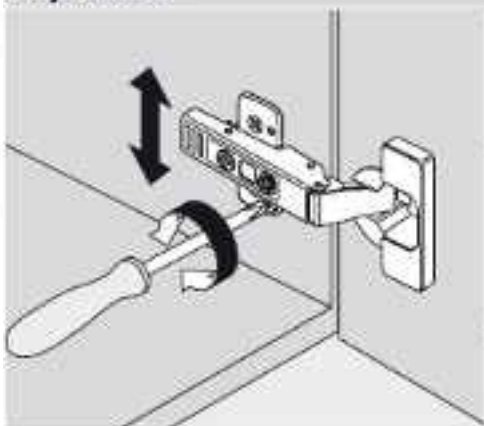

Height adjustment

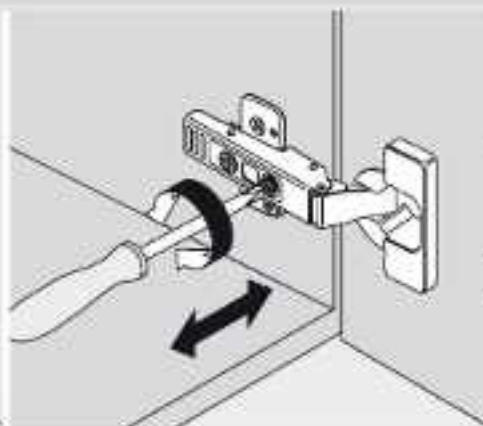

Side adjustment

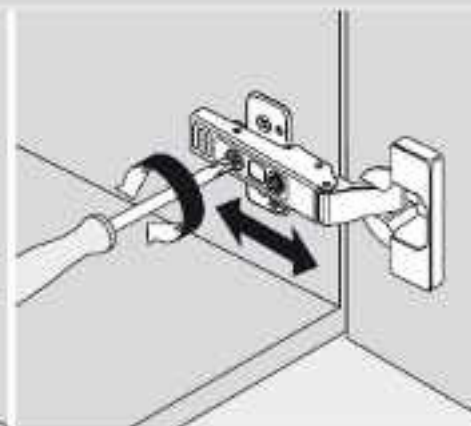

Depth adjustment

## 4: Drawers

Drawers are fitted with lift out stainless steel inners. For deep cleaning the drawers also have fully extendible runners with an easy release lever located on the side of the runner.

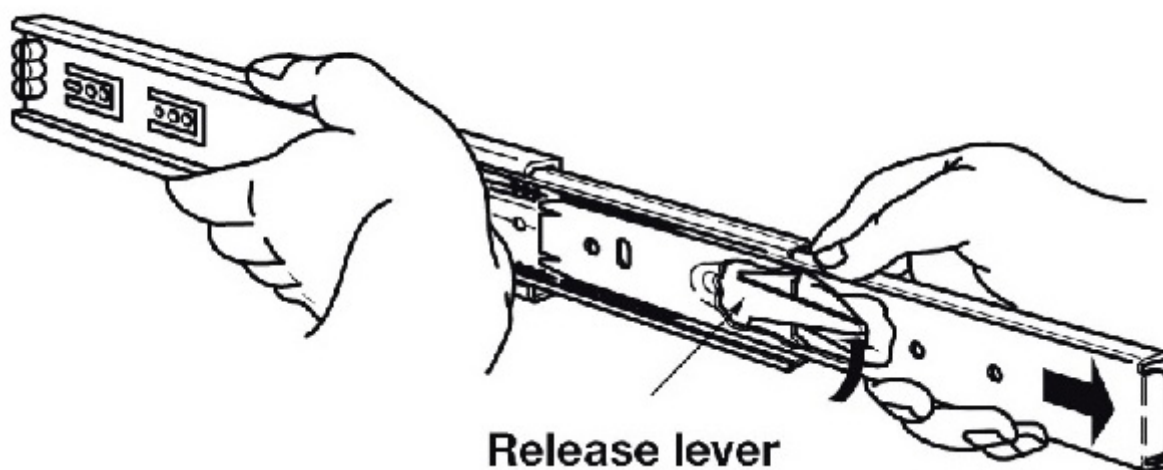
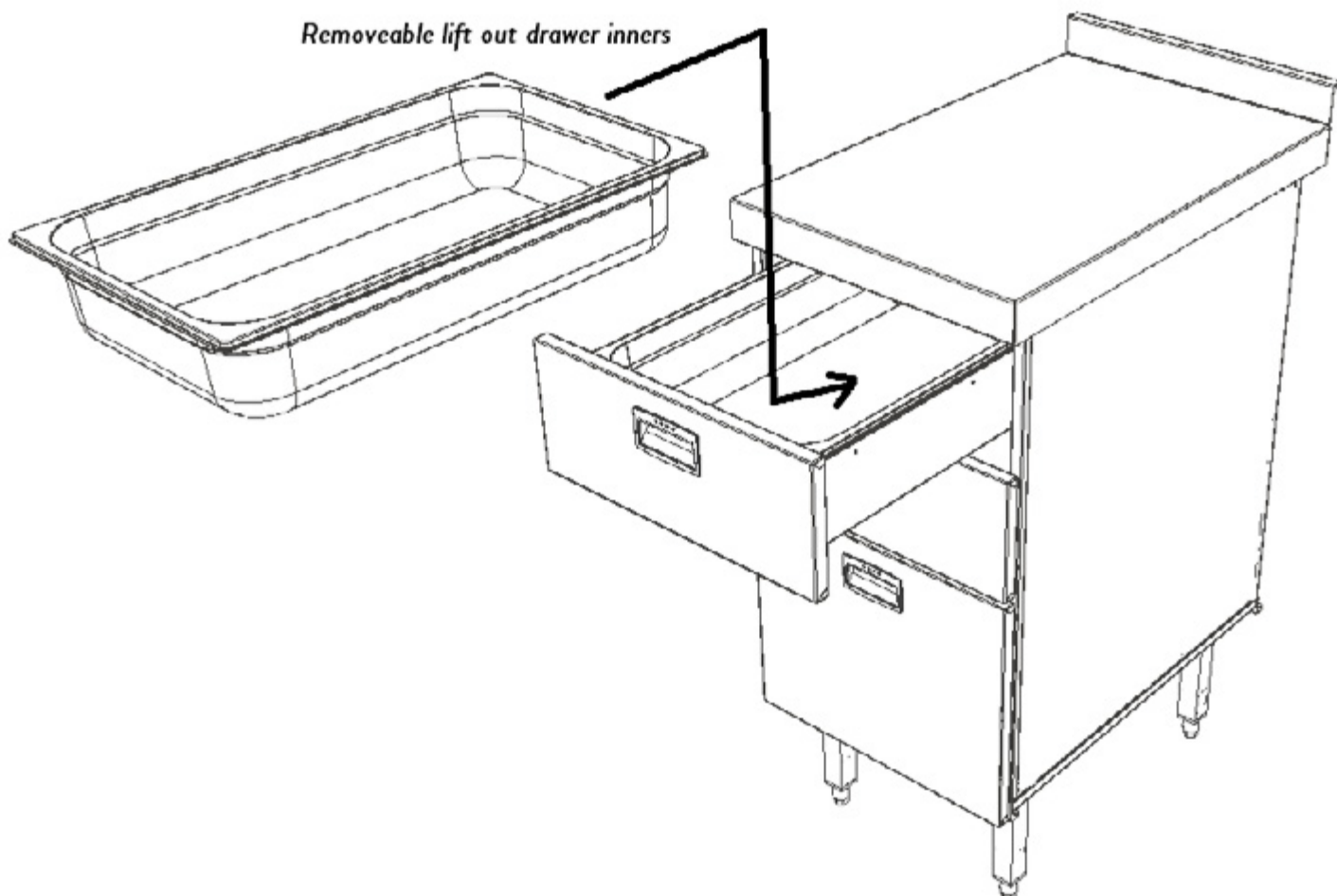



## 5: Wall-cupboards: Doors

### Hinged Doors

Soft closing easy to remove and adjust, fitted with sturdy easy clip in hinges and recessed handles. (See page 7.)

### Sliding doors

Easily lift off for cleaning fitted with unique skid pads and black recessed handles.

1. Hold the rear door at a slight angle & locate the door fully into the top track.
2. Swing the bottom of the door inwards connecting with the bottom track
3. Lower the door into the bottom track, & slide the door fully to the left.
4. The fitting of the outer door is the same as above.

Door removal is a reverse of the above.

**Fig. 1**

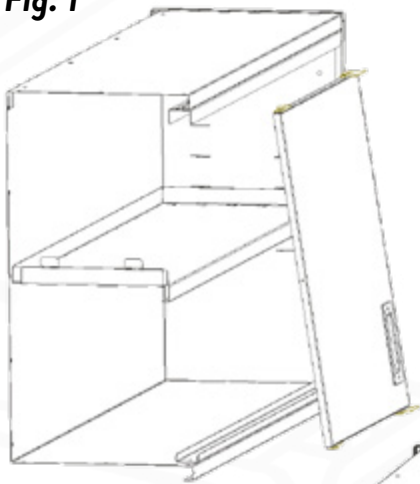

**Fig. 2**

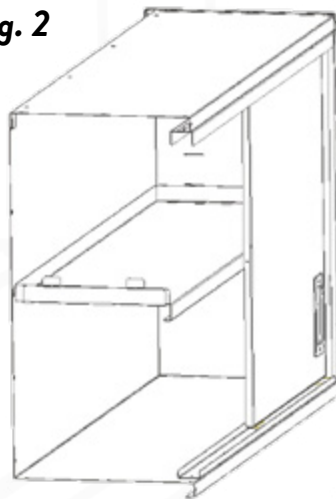

**Fig. 3**

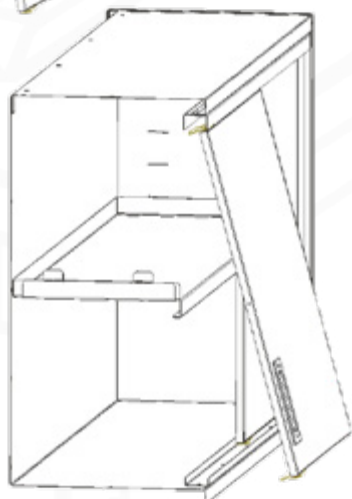

**Fig. 4**

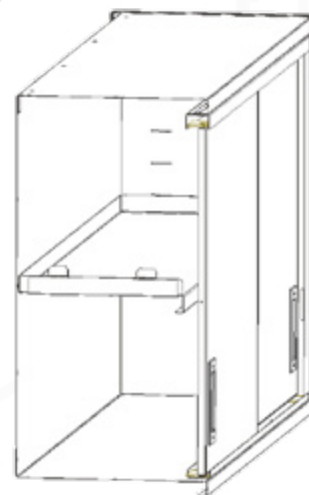

## 5: Wall-cupboards: Fitting

Commercial grade wall cupboards available in three standard lengths (800mm 1000mm or 1200mm with a choice of sliding or hinged doors. Wall cupboards are fully enclosed, fabricated in stainless steel. The internal mid shelf is removable and adjustable for height in 48mm increments. Designed with a flat roof as standard with the option of a sloping type roof.



Note: The weight capacity for each unit is 150kg

### Fitting: (wall fixing)

The wall units are hung onto brackets and double secured through the back on the bottom corners.

Wall units are usually fitted or hung with the bottom of the unit around 500mm above the worktop to give enough head height for working on the worktop.

The important thing is to work out how close to the ceiling you want the top of the wall unit.



Make sure the units are at the same height and are level all around the room.

Note: Base cabinets and worktops units are usually set at 900mm high.

If you have multiple wall units to hang it's a great idea to mark the height of the wall unit brackets at both ends of the wall and ping a chalk line between them.

Fix the brackets in place at the correct distance apart for each wall unit and directly onto the line you marked. (See page 11 for dimensions)

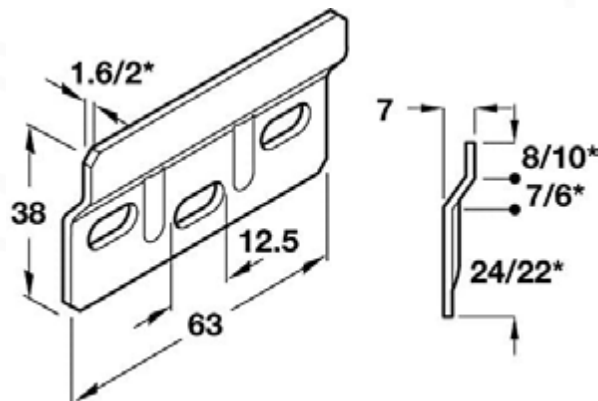

### Once the wall brackets are fixed,

- Hang the cupboard and adjust the top corner hanging brackets.
- There are two screws at the back of the internal wall unit bracket.
- One adjusts the height of the bracket for fine tuning on the wall
- The other pulls the unit in towards the wall to keep it tight against it.



Use a spirit level or a laser level to get the units straight and level

**There are two additional fixing points located on the bottom corners of the cupboard.**  
After fixing the top hangers mark and fix the bottom screws. (See page 11 for dimensions)

# 5: Wall-cupboards: Fitting

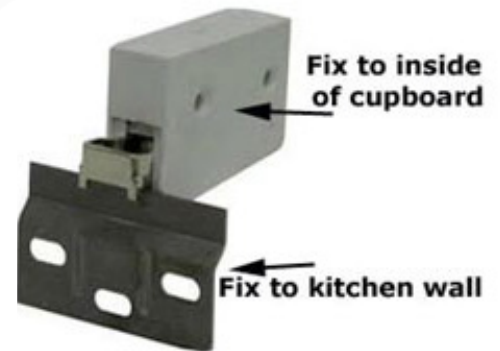
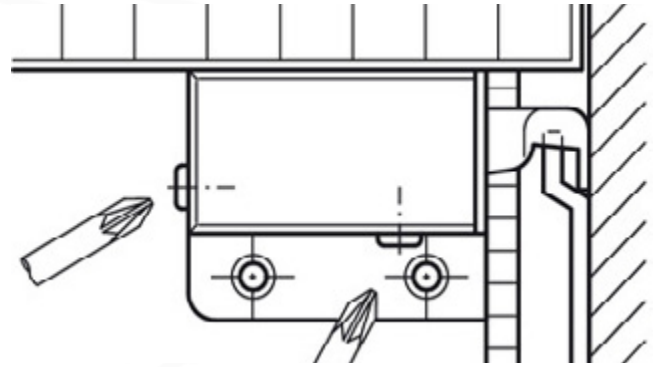
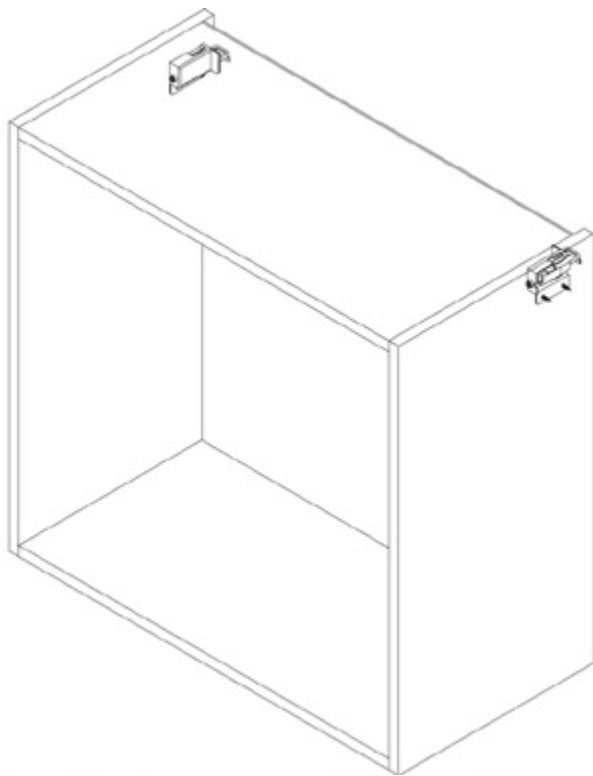

Wall-plate fixing centres

Model	Fixing bracket centres (Dimension "A" mm)
WC4HL/R	305
WC8H	705
WC10H	905
WC12H	1105

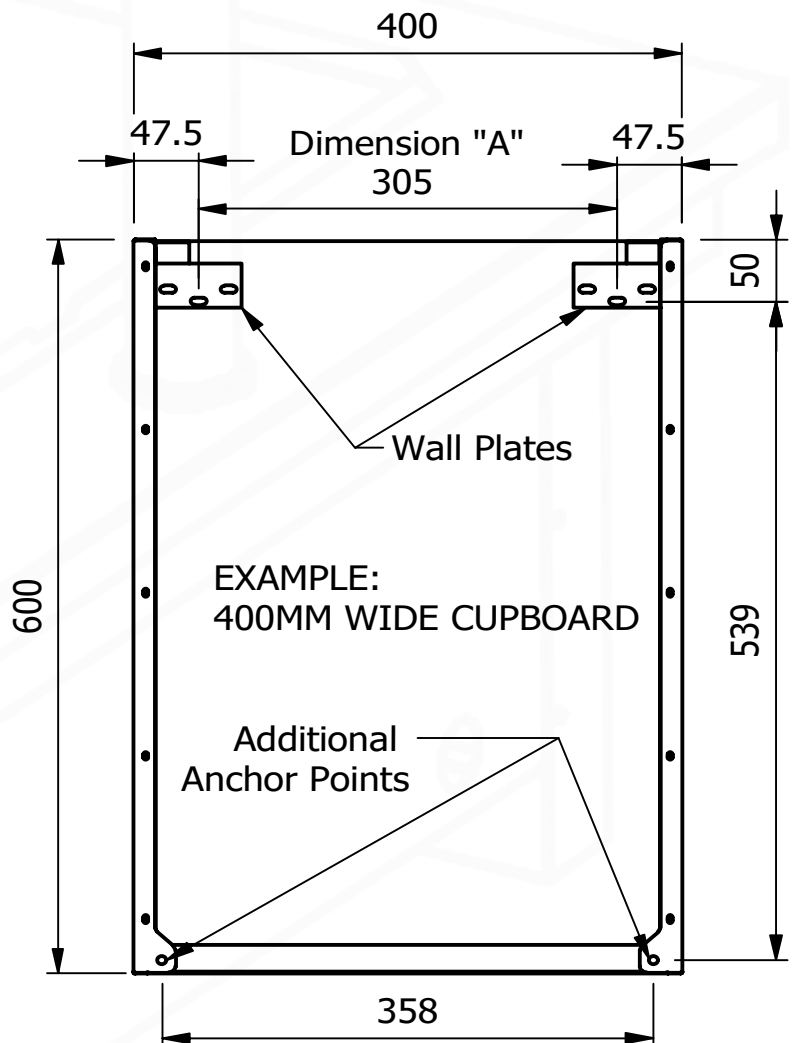

# 5: Wall-cupboards: Fitting



The correct and fit for purpose wall fixings must be use.

A wide range of fixings are available from expansion, universal or multi-purpose plugs to various anchor types.

Make your decision based on the material you're working on and the weight of the fixture.

Fixings should be selected according to:

- Base material, whether it is a solid (concrete, stone, etc.) or a hollow material (brick, breeze block, Wood, etc.)
- Size (according to plug type and the weight of load).

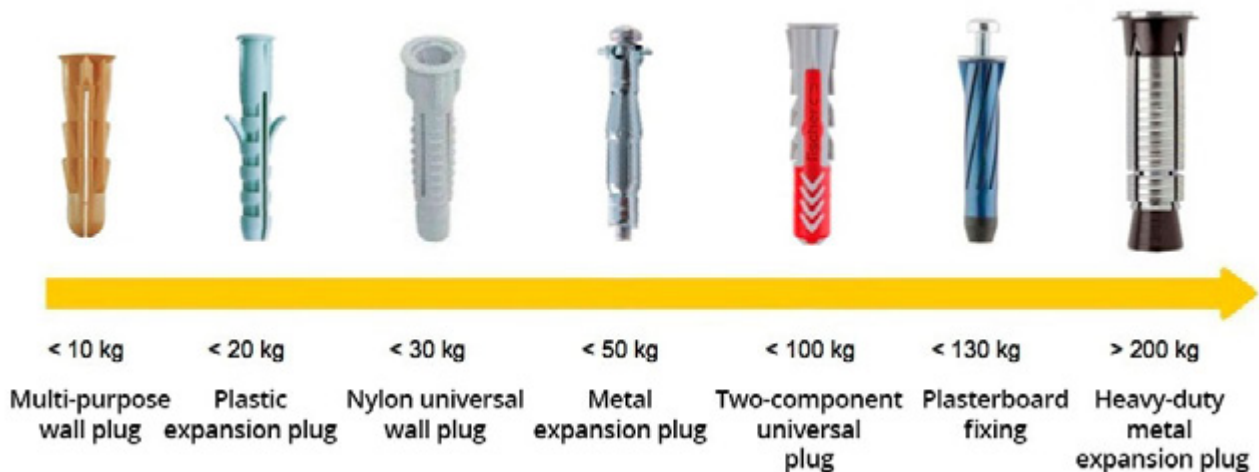

# 6: Cleaning

**Do not use scouring pads or abrasive cleaners of any type.**



**Do not use Solvents, bleach, Caustic Cleaners or biological powders**

## General fabrication and neutral units.

Cleaned with hot soapy water and thereafter dried & polished with a soft dry cloth or Leather chamois.

## Shelving and understructure

Should be similarly cleaned, always ensuring that the stainless steel is wiped in straight Strokes following the grain of the material.

## Cupboards

The top should be wiped as described above and the interior cleaned with a damp cloth, then dried & polished. If sliding doors are fitted within the unit these can easily be removed for cleaning as described in the instruction manual supplied with the unit.

Any drain holes must also be kept clear from blockage.

Glass panels and sneeze screens should be cleaned with a damp, clean cloth and finish off by carefully drying with a soft dry cloth or kitchen towel.

### **DO NOT**

- Leave wet cloths on the surface
- Do not use strong bleach, or material containing sodium hypochlorite or chlorine.
- Do not soak cloths or materials in bleaching fluids within sink bowl over a period of several hours.
- Do not use concentrated disinfectants within sink bowl. Always dilute and carry out full cleaning instructions.
- Do not use wire wool or abrasive cleaning Materials.
- Do not use acids for cleaning the floor around the unit.

### **DO**

- Wash down regularly with hot soapy water.
- Soap powders (non-abrasive) or cleaning powders may also be used to help remove stubborn deposits
- Rinse surface thoroughly with clean hot or cold water. dry with soft cloth.
- Clean undershelf & legs in the same manner, ensuring that they are properly rinsed with clean water & dried
- When cleaning stainless steel, always wipe in straight strokes following the grain of the Material.

# Thank you for choosing E&R Moffat!

Scan the QR code below to visit the  
E&R Moffat website for further information:



**Failure to use the correct cleaning  
procedure will invalidate the  
warranty of your product.**

