

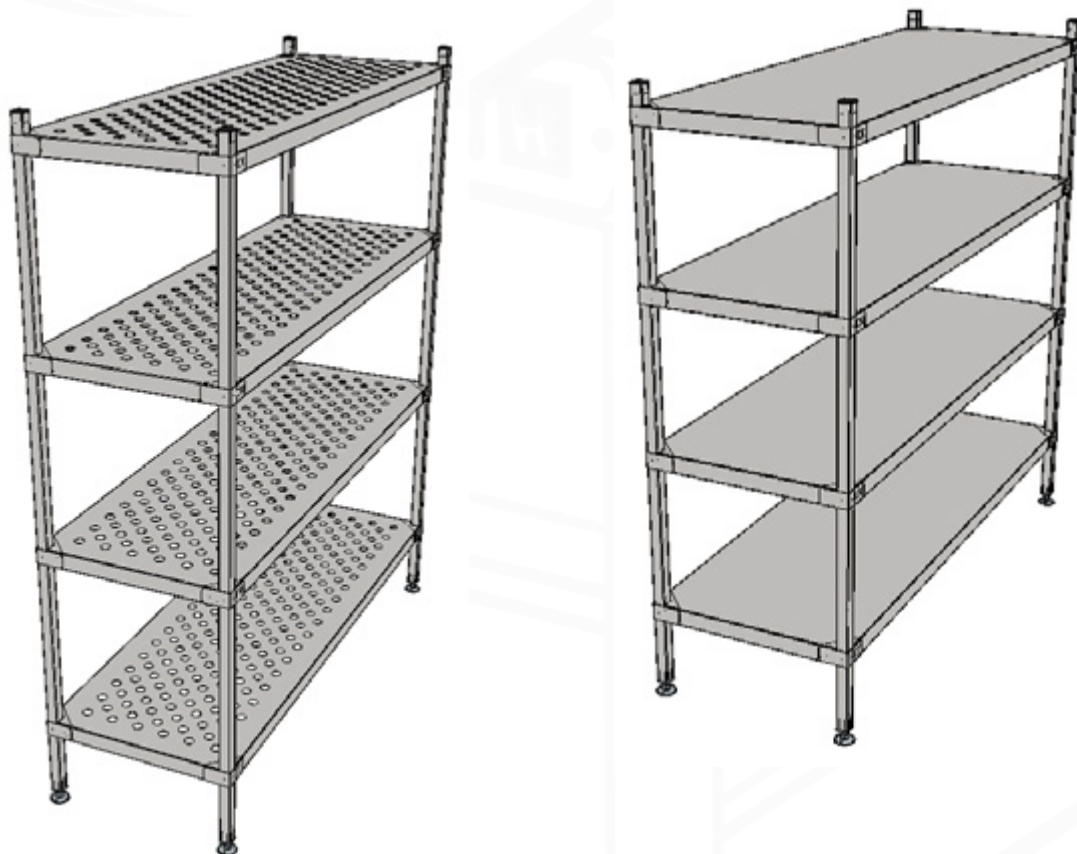

| Six-S Shelving



Operating & Service Manual

Manual 017 Issue 001 June 2020



1: Adjustable Corner Clamp Fitting

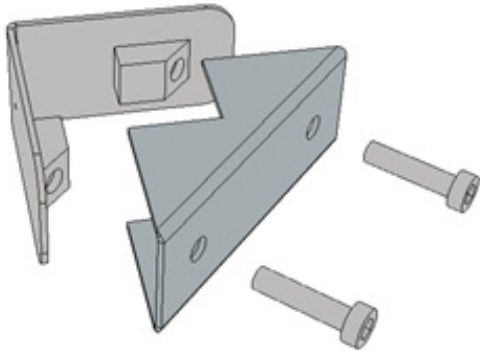

Two - part corner clamp and fixing screws

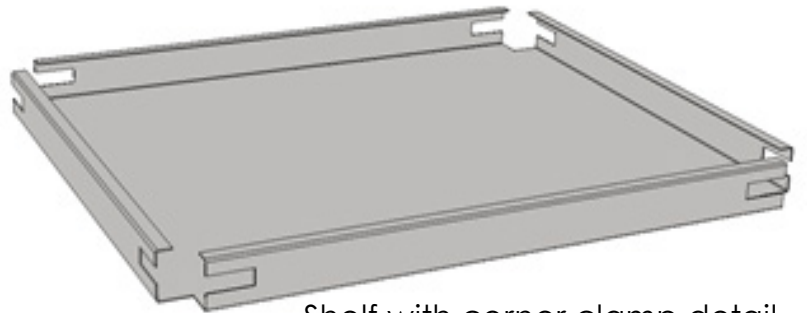

Shelf with corner clamp detail

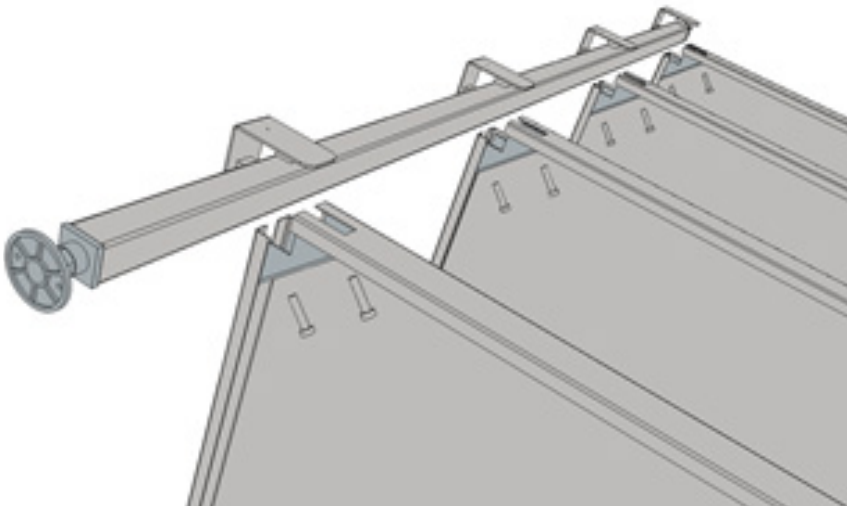

1. Shelving system should be assembled lying on its side.
2. Position the shelves at the required spacings. ensure feet are on the bottom.
3. Present the upright tube and outer clamp parts and screw together using the fixings supplied.

4. Repeated on all four corners.
5. Place complete assembly in the upright position.

6. Adjust feet setting the shelving unit level.

7. Check all shelves are in the required position and are set level.

8. Check all screw fixings are tight.





General Cleaning



Do not use scouring pads or abrasive cleaners of any type.

Do not use Solvents, bleach, Caustic Cleaners or biological powders

General fabrication and neutral units.

Cleaned with hot soapy water and thereafter dried & polished with a soft dry cloth or leather chamois.

Shelving and understructure

should be similarly cleaned, always ensuring that the stainless steel is wiped in straight strokes following the grain of the material.

Cupboards

The top should be wiped as described above and the interior cleaned with a damp cloth, then dried & polished. If sliding doors are fitted within the unit these can easily be removed for cleaning as described in the instruction manual supplied with the unit.

Any drain holes must also be kept clear from blockage.

Glass panels and sneeze screens should be cleaned with a damp, clean cloth and finish off by carefully drying with a soft dry cloth or kitchen towel.

DO NOT

- Leave wet cloths on the surface
- Do not use strong bleach, or material containing sodium hypochlorite or chlorine.
- Do not soak cloths or materials in bleaching fluids within sink bowl over a period of several hours.
- Do not use concentrated disinfectants within sink bowl. Always dilute and carry out full cleaning instructions.
- Do not use wire wool or abrasive cleaning Materials.
- Do not use acids for cleaning the floor around the unit.

DO

- Wash down regularly with hot soapy water.
- Soap powders (non-abrasive) or cleaning powders may also be used to help remove stubborn deposits
- Rinse surface thoroughly with clean hot or cold water. dry with soft cloth.
- Clean undershelf & legs in the same manner, ensuring that they are properly rinsed with clean water & dried
- When cleaning stainless steel, always wipe in straight strokes following the grain of the Material.



Thank you for choosing E&R Moffat!

Scan the QR code below to visit the
E&R Moffat website for further information:



**Failure to use the correct cleaning
procedure will invalidate the
warranty of your product.**

