

Overview

Mobile open racks for storage and transporting Gastronorm type containers or Gastronorm size trays. Ideal for maximising storage capacity and easy handling in bakeries, kitchens and general food service facilities. Fully welded stainless steel construction. Complete with 125mm diameter. Swivel castors two with brakes. The robust compact mobile design provides sturdy and hygienic conveyance in a busy catering kitchen.

The unique space saving "Z" shape allows multiple nesting when racks are empty.

Key Features:

- Zee racks designed to nest into each other when empty to enable five racks to occupy the area normally occupied by two
- Designed to take gastronorm containers or gastronorm size laminate trays
- Support runners manufactured from 1.2mm stainless steel.
- 72mm shelf pitch.
- Ideal for receiving, transporting, preparing, storing, serving or delivering food
- Uprights & diagonal ties in 30mm square section steel (type 304) welded together to form 'Z' shaped framework
- Compact heavy duty fully welded construction.
- Complete with 125mm dia. Swivel castors 2 with brakes.



Model ZMT



Model: ZMG

Model: ZMT
Fitted with large runners to suit trays

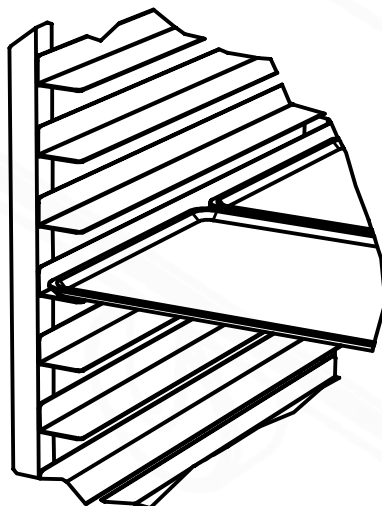

Model: ZMG
Fitted with anti tilt channel type runners to suit trays

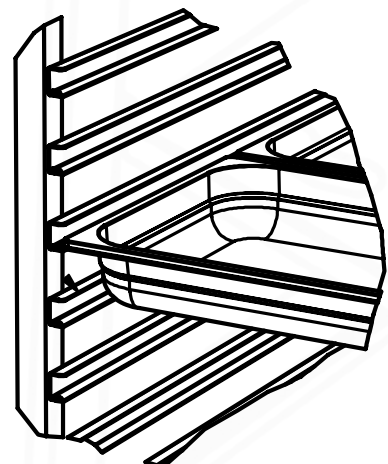



Model: ZMG

Model	Capacity Trays	Weight (kg)	L x W x H (mm)
ZMT	19 x 2/1 Gastronorm type trays or 38 x 1/1 Gastronorm type trays	28	750 x 680 x 1705

Model	Capacity Containers	Weight (kg)	L x W x H (mm)
ZMG	19 x 2/1 65mm deep GN type pans or 38 x 1/1 65mm deep GN type pans	28	750 x 680 x 1705

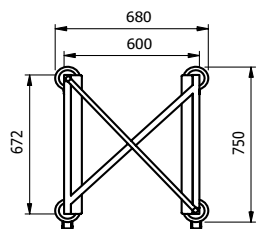

Model: ZMT

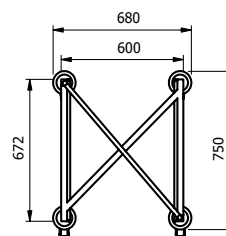

Model: ZMG

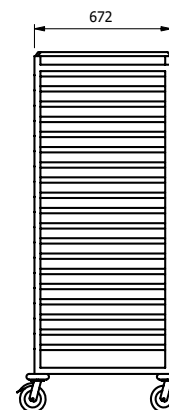
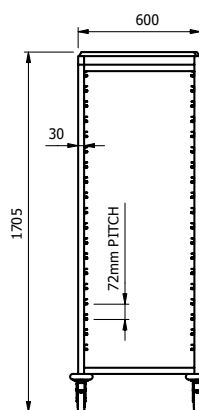
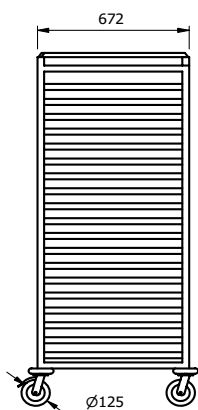
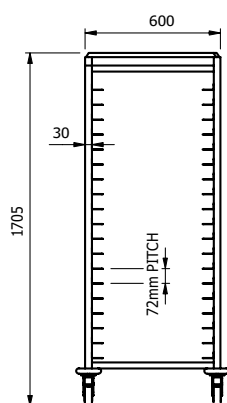

Compact space saving design
Example of 5 racks stacked together

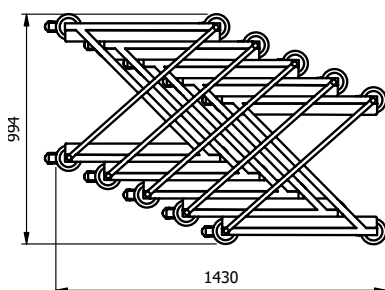

Compact space saving design
Example of 5 racks stacked together

